

THESE PLANS HAVE BEEN PREPARED BY MARK IV BUILDERS SOLELY FOR ITS USE AND SHOULD NOT BE RELIED UPON BY OTHER PARTIES.

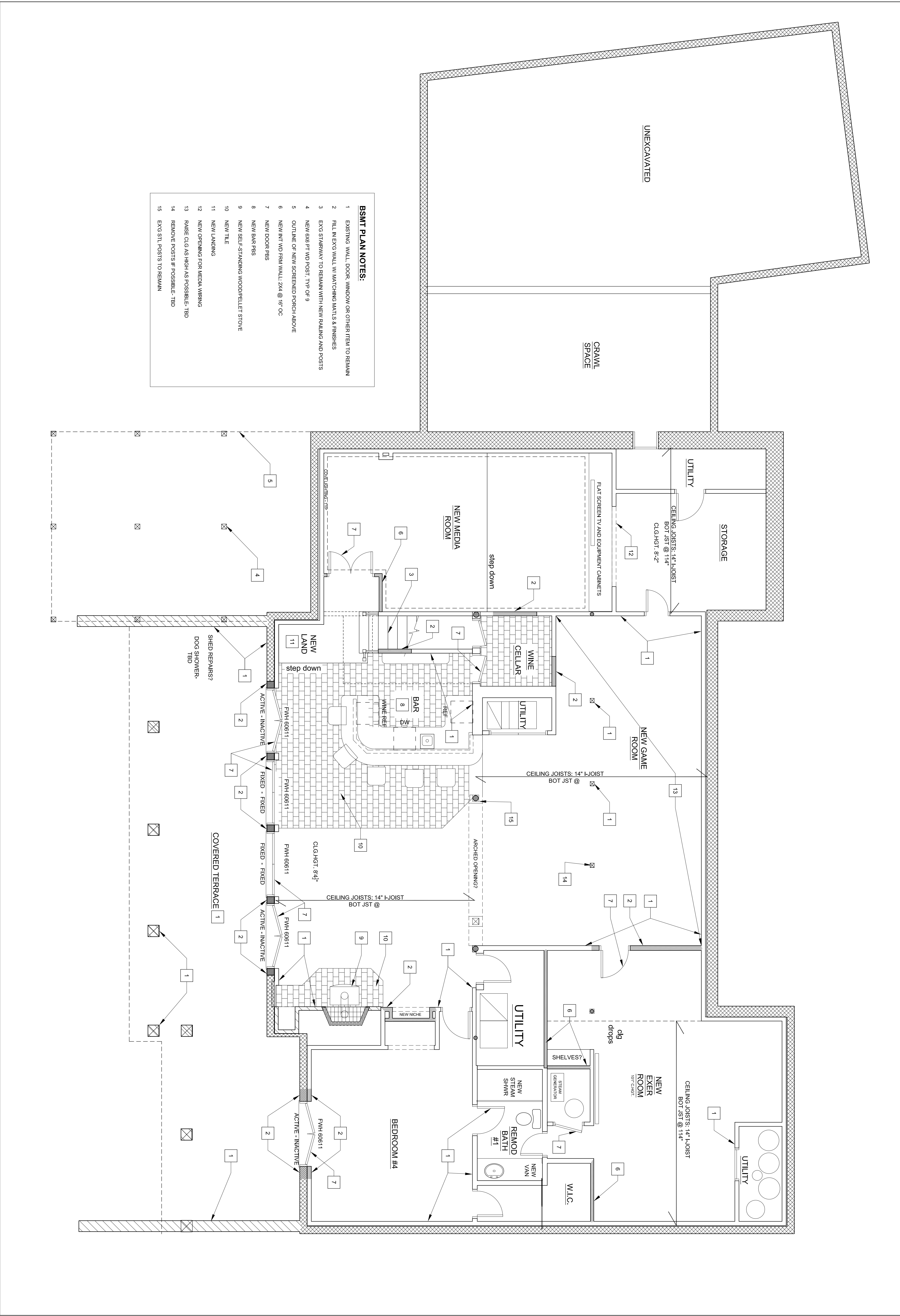

- BSMT PLAN NOTES:**
- 1 EXISTING WALL, DOOR, WINDOW OR OTHER ITEM TO REMAIN
 - 2 FILL IN EXG WALL W/ MATCHING MATLS & FINISHES
 - 3 EXG STAIRWAY TO REMAIN WITH NEW RAILING AND POSTS
 - 4 NEW 6x6 FT WD POST, TYP OF 9
 - 5 OUTLINE OF NEW SCREENED PORCH ABOVE
 - 6 NEW INT WD FRM WALL 2x4 @ 16" OC
 - 7 NEW DOOR PBS
 - 8 NEW BAR PBS
 - 9 NEW SELF-STANDING WOODPELLET STOVE
 - 10 NEW TILE
 - 11 NEW LANDINGS
 - 12 NEW OPENING FOR MEDIA WIRING
 - 13 RAISE CLG AS HIGH AS POSSIBLE - TBD
 - 14 REMOVE POSTS IF POSSIBLE - TBD
 - 15 EXG STL POSTS TO REMAIN

1 BASEMENT PLAN
1/4" = 1'-0"

THESE PLANS HAVE BEEN PREPARED BY MARK IV BUILDERS SOLELY FOR ITS USE AND SHOULD NOT BE RELIED UPON BY OTHER PARTIES.

THESE PLANS HAVE BEEN PREPARED BY MARK IV BUILDERS SOLELY FOR ITS USE AND SHOULD NOT BE RELIED UPON BY OTHER PARTIES.

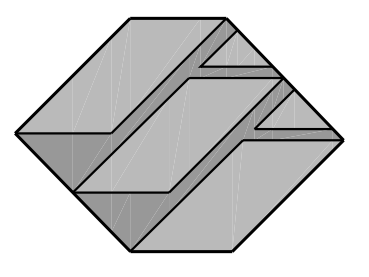

MARK IV
A TRADITION OF FINE HOMEBUILDING
AND REMODELING

JOHN AND SUSAN STINSON RESIDENCE
13301 SIGNAL TREE LANE
POTOMAC MD 20854
MONTGOMERY COUNTY

ALL CONDITIONS AND DIMENSIONS CONTAINED HEREIN ARE APPROXIMATE. ALL TRADES PERSONS INVOLVED WITH THE WORK MUST FIELD VERIFY ALL PERTINENT INFORMATION, CONDITIONS AND DIMENSIONS. SEVERE DIFFERENCES SHALL BE BROUGHT TO THE ATTENTION OF MARK IV BUILDERS AND THE PROPERTY OWNER. INFORMATION SHOWN ON THIS DOCUMENT INCORPORATES PROPRIETARY RIGHTS AND IS NOT TO BE DUPLICATED WHOLLY OR IN PART WITHOUT THE EXPRESS PERMISSION OF MARK IV BUILDERS. DO NOT SCALE DRAWINGS

REVISIONS	DATE
DESIGN REV	2-5-2018
DESIGN REV	2-14-2018
DESIGN REV	3-14-2018
TRADE PAY	3-22-2018
DESIGN REV	1-22-2018
DESIGN REV	1-31-2018

SHEET SCALE
AS NOTED
OR AS NOTED

BASEMENT PLAN

SHEET NUMBER
A-3.0
OF TOTAL